

Peacock Jewellery Set

- 2 x metres beadalon blue wire (BDW0717)
- 2 x metres beadalon purple wire (BDW0713)
- 5 x curved tubes gold plated (CVGP)
- 1 metre x trace chain gold plated (CHTRGP)
- 2 (1 packet of 6) x long ball wire gold plated (LBWGP)
- 1 (1 packet of 4) x small bolt ring gold plated (BRSGP)
- 5 (1 packet of 12) eyepins gold plated (EPGP)
- 5 (1 packet of 12) headpins gold plated (HPGP)
- 4 (1 packet of 30) 4mm jump rings gold plated (JR4GP)
- 10 x 4mm glass moon beads black (12A01)
- 5 x 8mm glass moon beads black (12C01)
- 3 x 4mm glass beads black (13F01)
- 1 x superglue (60E2)

You will also need a set of jewellery making pliers. A pair of multi pliers (CRMT) is a three in one tool combining flat nosed pliers, round nosed pliers and cutters.

1. To hang your beads, pick up a headpin and slide on a 4mm moon bead either side of the 8mm moon bead. Directly above the bead, bend the headpin over. Leaving a good centimetre, cut the headpin with the cutter part of your pliers. With the round nosed part of your pliers, curl the headpin into a loop and close the headpin curl. Repeat this for all 5 headpins.



2. For the top section of each feature item, take one eyepin, slide on a 4mm black bead, then the curved tube, leaving a good centimetre, cut the eyepin with the cutter part of your pliers. With the round nosed part of your pliers, curl the eyepin into a loop and close the loop, so that the tube fits quite snugly. With your pliers, open a jump ring add the headpin you made in step 2 and the bottom loop of the eyepin, underneath the curved tube, then close the jump ring.

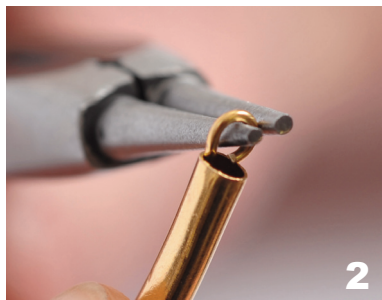

3. Measure your beadalon wire to approximately 14cm for each piece. For the necklace you will need 4 lengths of each colour. For each earring you will need 3 lengths of purple and 4 lengths of blue coloured beadalon wire. Thread one end of your beadalon wire into the curved tube, bend it into a curl and push the other end back into the tube, so they frame the beads in the centre. Repeat for all of your pieces of beadalon wire, alternating the colours, so the loops are all slightly different lengths. Add a touch of superglue where they enter the curved tube, to keep them in place. Repeat for earrings. For the necklace make the loops slightly larger.

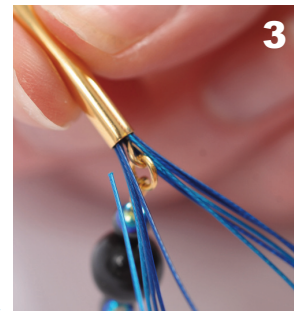

4. For the necklace, add a jump ring to the eyepin at the top of the feature item, thread the chain through the jump ring. Thread a curved tube onto the chain either side of the pendant. Add your last beaded headpins, with your pliers open the loop you made earlier, hook through the chain next to the curved tube and close the loop. Repeat on the other side. To finish, using your pliers, open a jump ring to add your bolt ring to the end of the chain, close the jump ring. Repeat on the other end of the chain for the tag. To complete your earrings, with your pliers open the loop at the bottom of your long ball wire, add the feature item and close the loop. Repeat and you have now made your Peacock Jewellery Set.

