

Amber Ramble Necklace & Bracelet

Materials

- 100g x plain glass bead mix amber (GLX14)
- 100g x fancy glass bead mix amber (GLXF14)
- 1x 0.6mm silver plated wire (SPW06)
- 1x 12 eyepins silver plated (EPSP)
- 24 x 7mm jump rings silver plated (JR7SP)
- 2 x 13mm toggle silver plated (TOG2SP)
- 1 x craft multi pliers (CRMT)

1. Using the cutting part of your pliers, cut approximately 45cm of wire. Add a stop bead by picking up a bead of your choice from the plain glass mix that is at least 5mm. Thread onto the wire, loop the end of your wire round and through the bead again and pull tight with your pliers. Trim the wire close to the bead and bend the end around into the centre of the bead.



2. Thread onto the wire a few beads of different size and colours. Bend the wire tightly around these beads wrapping them until they all feel secure. At this point if you wish, add a few more beads to make a larger cluster. When you are happy with the size and shape of your cluster, continue wrapping the beads as tightly as possible until you almost reach the end of your wire. Bend the end of the wire into the centre of the cluster. You will need eleven plain glass clusters for your necklace.



3. Take four large beads of your choice from the fancy glass mix. Thread each of them onto an eyepin, with a bead from your plain mix either side. Trim the eyepin approximately 1cm above the beads, bend it around into a loop and close the loop.

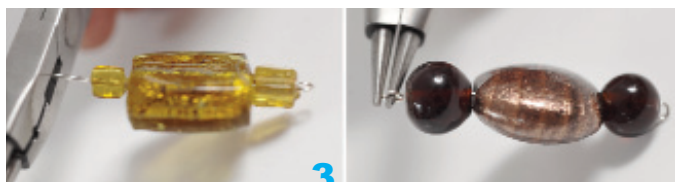

4. To construct your necklace, open a jump ring, thread onto a plain glass cluster, add the next link to the jump ring and close it. Add the larger fancy beads in the following order. The second, sixth, eleventh and thirteenth link of your necklace.



5. With your pliers, open a jump ring and attach the round part of the toggle to one end of your necklace, attach the bar to the other end and you have made your necklace.



6. Repeat these steps to make a matching bracelet. Make six plain glass clusters, slightly smaller than for the necklace and one link with a large fancy bead, use this one for the second link.

