

Retro Style Necklace & Bracelet

Materials:

- 7 x red polka dot Pandora style beads (GLCH11)
- 10 x black polka dot Pandora style beads (GLCH01)
- 16 x 10mm pressed round black bead (13C01)
- 16 x plain cup silver plated (PCSSP)
- 8 x eyepins silver plated (EPSP)
- 4 x 5mm jump ring silver plated (JR5SP)
- 2 x 13mm toggle silver plated (TOG2SP)
- 1 metre x light chain silver plated (CHLSP)
- 1 x set of pliers including cutters, round nose and flat nose. (CPSX)



1. Onto an eyepin thread one plain cup, a 10mm black pressed bead, one black and white Pandora bead, another black pressed bead and a plain cup. Trim a good centimetre above the bead and bend into a loop. Make seven more (keep three aside for your bracelet).



2. For the top line of your necklace cut your chain in the following lengths: 16cm x 1, 3.5cm x 1, 3cm x 2, 4cm x 1 and 9cm x 1.
For the looped section cut the following lengths: 5cm x 3, 3cm x 2 and 2cm x 1.



3. Take your 16cm length, using your pliers open the link at the end of the chain and attach the bar section of your toggle. Thread on two red and white Pandoras. Attach a jump ring to the other end of your chain and add your 3.5cm length (for the top line) and one 5cm length (for the looped section). Close the jump ring.

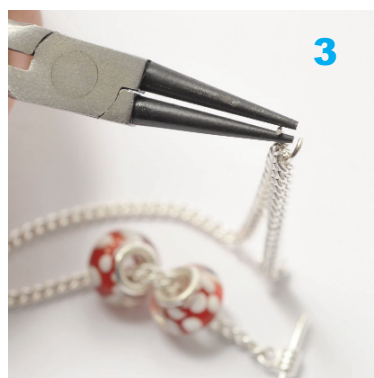

4. Using your pliers attach a beaded eyepin to each of the lengths of chain followed by two 3cm lengths of chain. Thread on a red and white Pandora bead and attach a beaded eyepin to the two chains on the top line and the looped section. Add a 4cm length of chain to the top line.



5. For the looped section attach two 5cm lengths of chain, thread on a red Pandora bead attach a beaded eyepin. Attach your 2cm chain. Add a jump ring to the end of the chain, join it to the top line and add your 9cm chain and close the jump ring. Thread on a red Pandora bead. Open the last link of the chain and attach your toggle.



6. Make your bracelet in the same way. Cut eight 2cm lengths of chain. Attach the beaded eyepins as in step 4. Alternate the colours between red and black for the Pandoras that are threaded onto the chain. Use a jump ring to attach the toggle.

