

## Chunky Pearl Necklace

### Materials:

- 1 packet (20) x 14mm glass pearls turquoise (GLHP14-18)
- 1 packet (50) x 12mm glass pearls turquoise (GLHP12-18)
- 1 packet (100g) x mixed glass pearls blue (GLXHP17)
- 1 packet (100) x headpins (HPBA)
- 1 x 17mm toggle black antique (TOG1BA)
- 1 packet (10) 8mm jump rings black antique (JR8BA)
- 1m x medium chain black antique (CHMBA)

You will also need 1 x set of craft multi pliers. (CRMT)



**1.** Thread one bead onto a headpin. Using the cutting part of your multi pliers, trim a good centimetre above the bead and bend at a right angle directly above the bead.

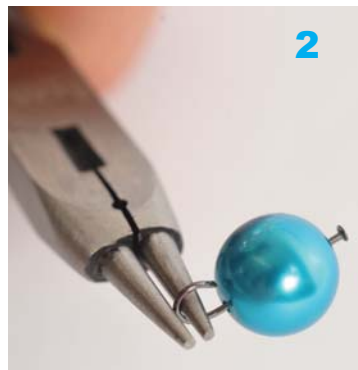

**2.** Using the round nosed section of your pliers, curl the headpin into a loop but do not close completely just yet. Repeat steps 1 and 2 until you have used up all the headpins.



**3.** Cut 40cm of chain. To add your first bead, find the middle of the chain. Using the loop you made, hook one of large beads on to a link on the chain. Using the round nosed part of your pliers, close the loop completely.

**4.** When adding your beads place the largest ones in the middle and gradually introduce smaller ones as you work your way outwards. Make them as clustered as possible in the middle and slightly sparser at the ends.



**5.** To attach your toggle, open up a jump ring and add it to one end of the chain. Hang the loop of the toggle onto the jump ring and close it ensuring there is no gap.



**6.** Repeat on the other end of the chain with the other half of your toggle.

