

Coral Reef

Materials

- 1 metre x trace chain black antique (CHTRBA)
- 1 x 5g Silver lined 8/0 rocailles aqua (S825C)
- 1 x 5g Silver lined 8/0 rocailles turquoise (S818C)
- 1 x 5g Silver lined 8/0 rocailles pink (S822C)
- 1 x 500 3mm spacer beads silver plated (25B331)
- 1 x 8 5mm spacer beads silver plated (25B531)
- 2 x 100 headpins black antique (HPBA)
- 2 x 30 4mm jump rings black antique (JR4BA)
- 1 x 25 5mm jump ring black antique (JR5BA)
- 1 x trigger clasp black antique (TRGBA)
- 1 X 6 long ballwire black antique (LBWBA)

You will also need a pair of craft multi pliers (CRMT)

1. Measure and cut a 44cm length of trace chain. Using the round nosed part of your pliers open a 5mm jump ring, attach a trigger clasp to one end of the chain and close the loop. Add a 5mm jump ring to the other end of the chain.

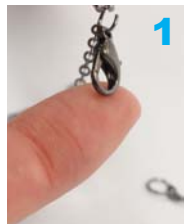

2. Onto a headpin thread a 3mm spacer bead followed by a roccaille. Using the cutting part of your pliers trim the headpin approximately one centimetre above the bead. With the round nosed part of your pliers bend the headpin into a loop and close. You need to make approximately 103 beaded headpins for the necklace. Make 16 pink headpins and the rest in aqua and turquoise.

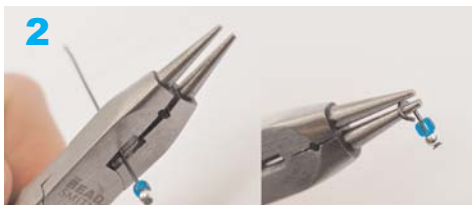

3. Measure and cut 8cm of trace chain. Open a 4mm jump ring attach it to the first link in your 8cm piece of chain, add four of the beaded headpins in any colour and close the jump ring. Miss a link and repeat for the length of the chain. Space the pink rocailles throughout the length of the chain.

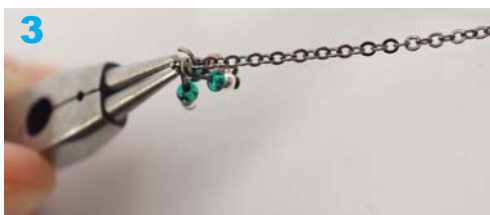

Top tip. Make the chain on the necklace longer if you wish as you will have some left over to play with.



Make this tactile jewellery set inspired by coral reefs.

4. To taper the end of the necklace open a 4mm jump ring, loop through the last jump ring added to the chain, add two beaded headpins and close the jump ring. Repeat twice more. Open another 4mm jump ring, loop through the last jump ring added and attach a single beaded headpin and close the jump ring.



5. Onto a headpin thread a 5mm spacer bead. Using the cutting part of your pliers trim the headpin approximately one centimetre above the bead. With the round nosed part bend the headpin into a loop and close. Make four more. Open a 5mm jump ring and hook through the second link of the 8cm beaded chain. Add the headpins, attach to the centre of the 44cm chain and close the loop.



6. Cut a 2.5cm length of trace chain. Make 36 beaded headpins and add to the length of chain in the same way as the necklace. Make 5 pink headpins and the rest in aqua and turquoise. Space the pink rocailles throughout the length of the chain. Onto a headpin thread only a 3mm spacer bead. Trim the headpin approximately one centimetre above the bead, bend the headpin into a loop and close. Make two more.



7. Open the loop at the bottom of the long ballwire, hook through the second link of the chain, attach the beaded headpins and close the loop. Repeat to make a pair.

